

- REMOVE ALL BURRS AND SHARP EDGES -

- DO NOT SCALE -

- IF IN DOUBT, ASK -

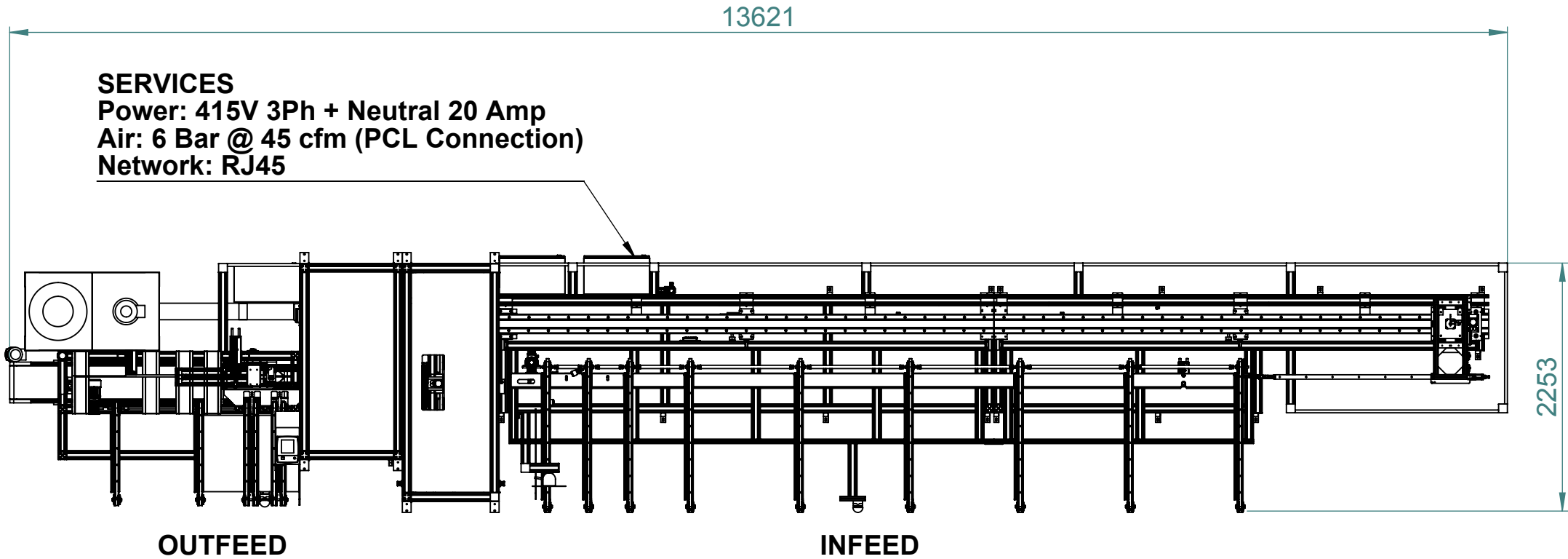
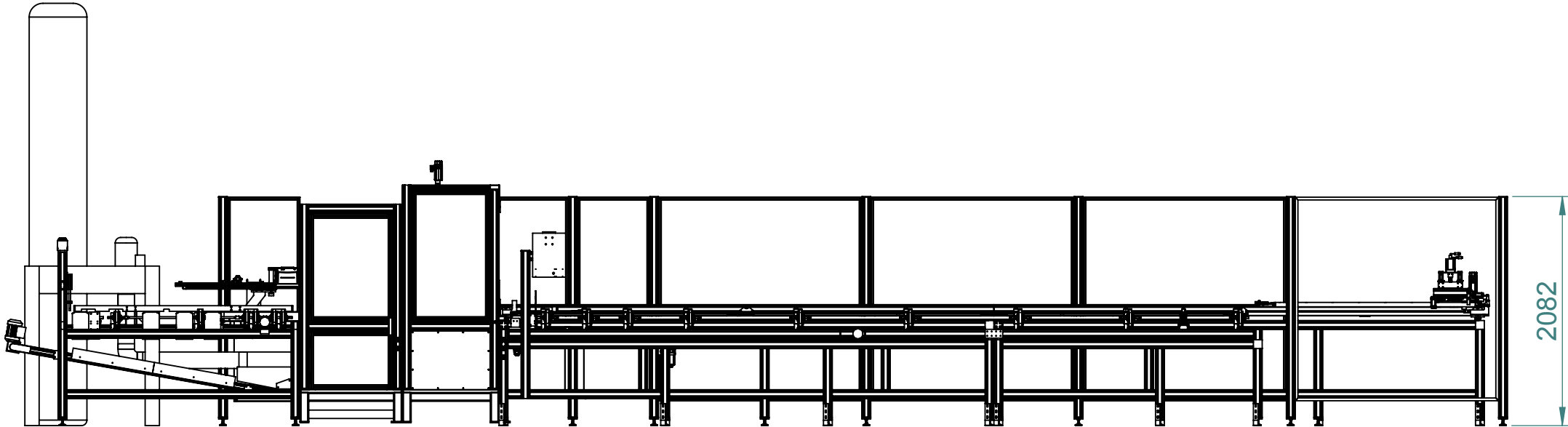

SERVICES
Power: 415V 3Ph + Neutral 20 Amp
Air: 6 Bar @ 45 cfm (PCL Connection)
Network: RJ45

Right to Left Feeding Autoflow 2

Stuga

MACHINERY LLP

© This drawing and the information there on is the property of Stuga machinery LLP. Drawings may not be sold, lent or copied without the prior consent of Stuga Machinery LLP and must be returned on demand

Stuga Machinery LLP
4 Brinell Way
Harfreys Industrial Estate
Great Yarmouth,
NR31 0LU
Tel: 0845 652 8685
Fax: 0845 652 8695
Web: www.stuga.co.uk

1	06/06/2011	NLC	Original								
Issue	Date	By	Description of Change				ECR No.				
<div>1. Tapped Holes,Use ISO Coarse Unless Otherwise Stated</div> <div>2. Tolerances, Decimal Places 0 = ±0.1mm, 0.0 = ±0.1mm, 0.00 = ±0.05</div> <div>3. Remove All Burrs and Sharp Edges</div> <div>4. If In Doubt Ask</div>			Drawing Title				Scale unless otherwise stated				
			Autoflow 2				1:50				
			Drawn		Date		Chk'd	Date	Sheet		
Material		Opp. Hand		NLC		06/06/11		-	-	1 of 2	
Finish		Weight		Drawing No.					Iss		
See Part Notes		2977.44 kg		J0001000					1		

- REMOVE ALL BURRS AND SHARP EDGES -

- DO NOT SCALE -

- IF IN DOUBT, ASK -

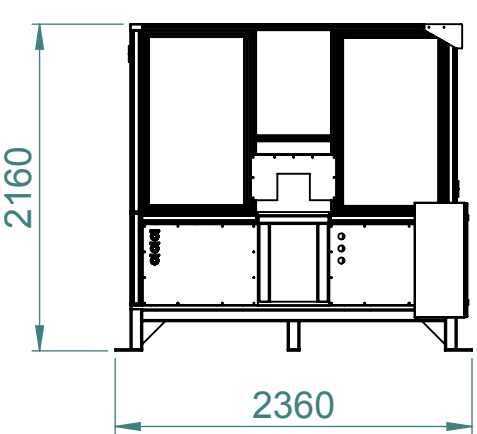

MACHINING CENTRE
Approx 1000kg

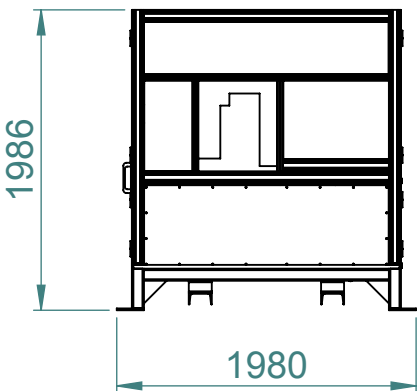
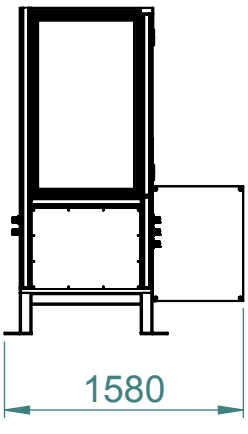

SAWING CENTRE
Approx 750kg

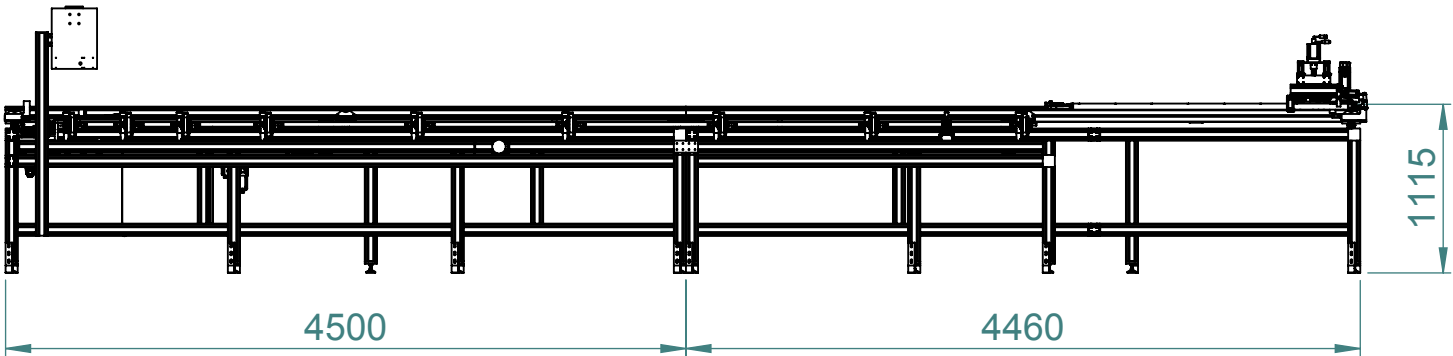
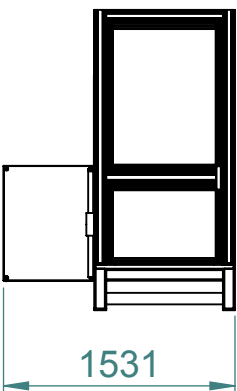

INFEED TABLE
Approx 1000kg
(Delivered in 2 parts, as shown)

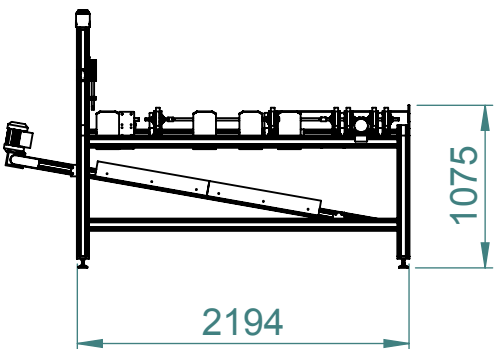
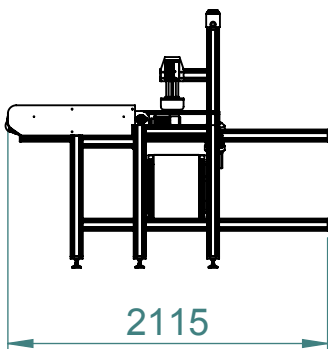

OUTFEED TABLE
Approx 250kg

All dimensions and weights are approximate

<div><div><div>Stuga</div><div>MACHINERY LLP</div></div><div><div>©</div><div>This drawing and the information there on is the property of Stuga machinery LLP. Drawings may not be sold, lent or copied without the prior consent of Stuga Machinery LLP and must be returned on demand</div></div></div>	<div><div>Stuga Machinery LLP</div><div>4 Brinell Way</div><div>Harfreys Industrial Estate</div><div>Great Yarmouth,</div><div>NR31 0LU</div><div>Tel: 0845 652 8685</div><div>Fax: 0845 652 8695</div><div>Web: www.stuga.co.uk</div></div>	<div><div>1. Tapped Holes, Use ISO Coarse Unless Otherwise Stated</div><div>2. Tolerances, Decimal Places 0 = ±0.1mm, 0.0 = ±0.1mm, 0.00 = ±0.05</div><div>3. Remove All Burrs and Sharp Edges</div><div>4. If In Doubt Ask</div></div>	<div>Drawing Title</div> <div>Autoflow 2</div>				<div>Scale</div> <div>unless</div> <div>otherwise</div> <div>stated</div> <div>1:50</div>
	<div>Material</div>	<div>Opp.</div> <div>Hand</div>	<div>Drawn</div> <div>NLC</div>	<div>Date</div> <div>06/06/11</div>	<div>Chk'd</div> <div>-</div>	<div>Date</div> <div>-</div>	
	<div>Finish</div>	<div>Weight</div> <div>2977.44 kg</div>	<div>First Angle Projection</div> <div>Dimensions in millimeters</div> <div>unless otherwise stated</div> <div>Do not scale, if in doubt ask</div>				<div>Sheet</div> <div>2 of 2</div>
	<div>See Part Notes</div>					<div>Drawing No.</div> <div>J0001000</div>	<div>Iss</div> <div>1</div>